

# 915 iS ENGINE

## WIRING HARNESS

Item No.	Part No	Description	Qty. Req.	Price
1-21	665-577	WIRING HARNESS	1	CALL
4	881-312	FUSE BOX CONNECTOR	2	\$181.01
5	881-306	AAPTS CONNECTOR	2	\$49.85
6	881-298	CPS CONNECTOR	2	\$47.99
7	881-302	OPS, BPS AND MAPS CONNECTOR	3+2a	\$40.65
8	881-296	CTS A OTS A KNOCK CONNECTOR	3	\$39.84
9	881-292	MATS CONNECTOR	2	\$35.37
10	481-455	EGT CONNECTOR	2	CALL
11	881-308	TPS CONNECTOR	1	\$33.60
12	881-300	INJ CONNECTOR	8	\$35.37
13	881-310	IGNITION COIL CONNECTOR	1	\$25.34
14	881-304	FUEL PUMP CONNECTOR	2	\$135.49
15	481-452	CONNECTOR PCV A	1	CALL
16	481-453	CONNECTOR PCV B	1	CALL
17	481-454	CONNECTOR PCV C	1	CALL
19	964-059	CABLE SHOE M6	1	\$1.23
20	864-011	FASTON CONNECTOR 6.3x0.8	1	\$1.23
21	966-057	RING TERMINAL	4	CALL
22	881-294	CONNECTOR SET HIC A + HIC B	1	\$191.16
23	251-691	CABLE CLAMP 12/M6	2	\$3.43
24	827-961	WASHER 6.4	2	\$0.31
25	840-391	ALLEN SCREW M6x14	2	\$1.00
26	866-716	TIE WRAP 203x7.6 MM	5	\$0.66
27	866-714	TIE WRAP 142x3.2 MM	5	\$0.35
28	638-140	CLAMP	5	CALL
29	881-240	CONNECTOR SET HIC - NON-CERTIFIED	1b	\$194.12

a for OPS, MAPS and BPS.  
b HIC A, HIC B and FUSE BOX 3-pole.

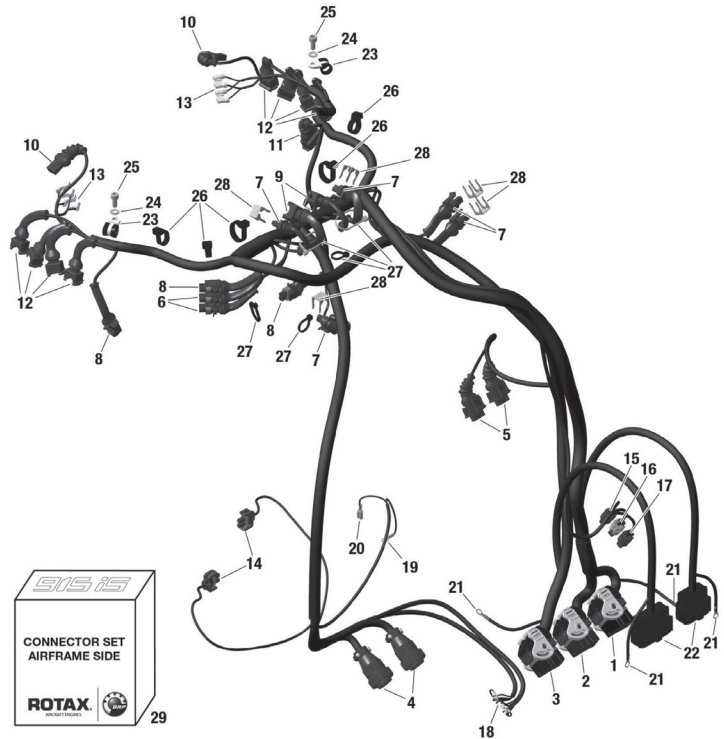

**RTX**

## EXHAUST SYSTEM, EXHAUST TEMPERATURE SENSOR

Item No.	Part No	Description	Qty. Req.	Price
1	893-105	TURBOCHARGER ASSEMBLY	1	CALL
2	851-296	TURBOCHARGER BRACKET	1	CALL
3	851-305	REINFORCEMENT SHEET	1	CALL
4	940-583	HEX. SCREW M8x16 STAINLESS STEEL	3	\$3.19
5	940-173	STUD M8x19.5/13	5	\$7.05
6	250-640	SEALING RING A 12x18-CU	1	\$1.92
7	956-489	VALVE HOUSING	1	CALL
8	430-225	O-RING 15.9-2.3	1	\$8.71
9	656-770	OIL SUMP ASSEMBLY	1	CALL
10	640-601	ALLEN SCREW M6x50	2	\$6.92
11	250-055	O-RING 18x2.5-N, FPM 75	1	\$1.78
12	640-860	PLUG SCREW ASSEMBLY M22x1.5	1	CALL
13	979-475	MUFFLER ASSEMBLY	1	CALL
14	250-313	WASHER 8.4 STAINLESS STEEL	11	\$1.23
15	242-203	HEX. NUT M8 STAINLESS STEEL	9	\$1.69
16	851-680	EXHAUST BRACKET	1	CALL
22	851-682	EXHAUST BRACKET	1	CALL
23	851-445	CLAMP 74-79	1	CALL
24	979-561	EXHAUST MANIFOLD ASSEMBLY	1	CALL
25	840-993	ALLEN SCREW M8x30	4	CALL
26	953-306	MANIFOLD BRACKET ASSEMBLY	1	CALL
27	240-073	ALLEN SCREW M8x20	1	\$1.61
28	440-107	ALLEN SCREW M8x50	1	\$1.99
29	926-400	WASHER 8.4/15/0.5	AR	\$3.17
29	926-401	WASHER 8.4/15/1	AR	\$3.37
29	926-402	WASHER 8.4/15/1.5	AR	\$3.61
30	940-366	STUD M8x23/20	8	\$6.50
31	979-501	EXHAUST PIPE ASSEMBLY CYLINDER 1	1	CALL
32	979-511	EXHAUST PIPE ASSEMBLY CYLINDER 2	1	CALL
33	979-521	EXHAUST PIPE ASSEMBLY CYLINDER 3	1	CALL
34	979-531	EXHAUST PIPE ASSEMBLY CYLINDER 4	1	CALL
35	842-951	LOCK NUT M8-SW12	8	CALL
36	866-262	TEMPERATURE SENSOR	2	CALL
38	239-131	COMPRESSION SPRING 22.0	1	\$5.33
39	232-440	BALL 5.556 MM	1	\$0.66
41	950-141	SEALING RING A 8x13	2	\$1.30
42	840-730	BANJO BOLT M8x1x17	1	\$53.95
43	979-570	EXHAUST PIPE CLAMP (Cylinder 2 and 4)	4	CALL
44	901-442	HEX. NUT ISO 7042 - M5 - A2 (Cylinder 2 and 4)	4	CALL
45	240-153	ALLEN SCREW M5X10 ISO 4762-A2-70 (Cyl. 2 and 4)	4	CALL
46	244-213	WASHER 6.4	4	\$1.00

