

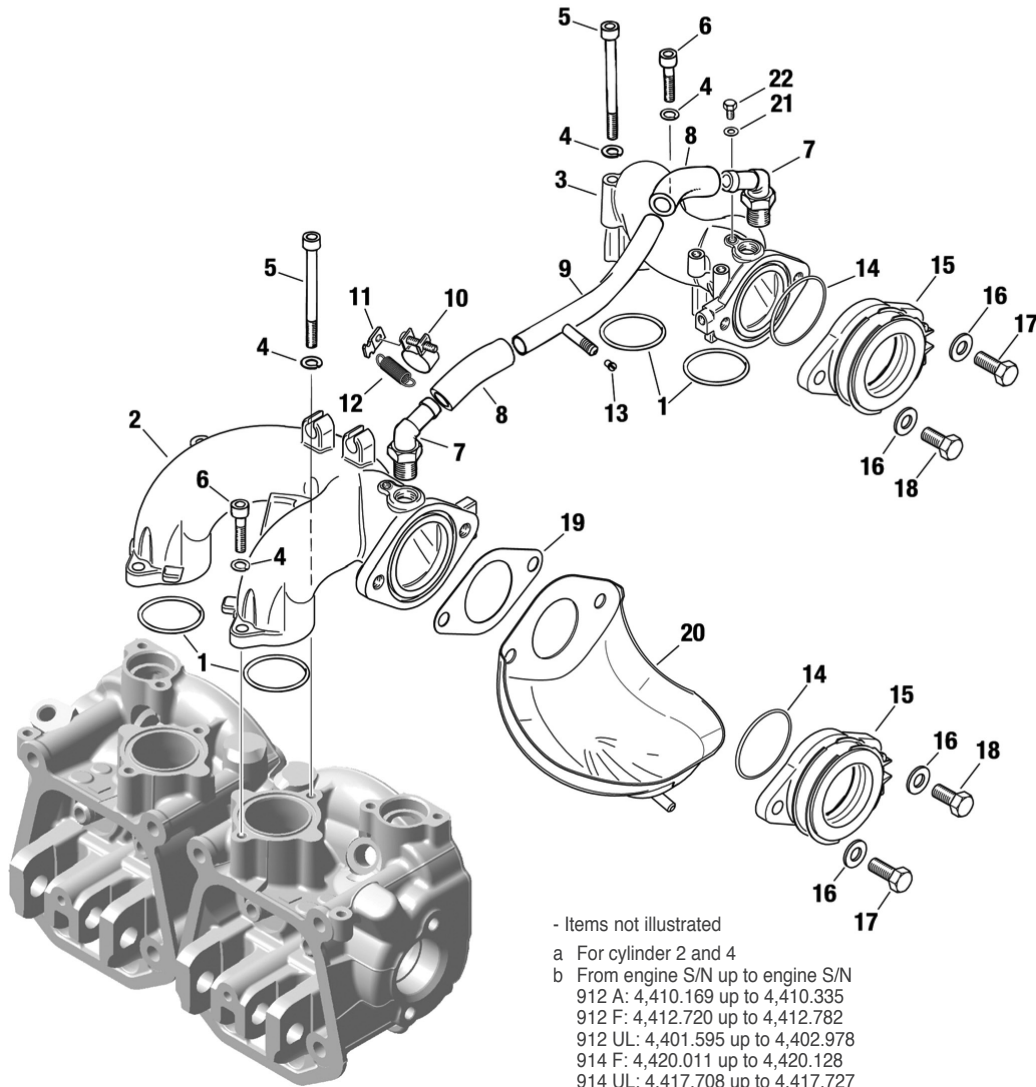

RTX



INTAKE MANIFOLD, COMPENSATING TUBE ASSEMBLY, RUBBER FLANGE ASSEMBLY

Item No.	Part No	Description	Qty. Req.			Price
			912 UL	912 ULS	914 UL	
1	230-910	O-RING 34x2	4	4	4	\$11.91
2	867-932	INTAKE MANIFOLD	1a	1a	1a	\$443.87
4	827-962	WASHER 6.4	8	8	8	\$0.31
4	945-831	LOCK WASHER A6	8	8	8	\$0.23
5	241-871	ALLEN SCREW M6x70	4d		4d	\$1.92
5	240-531	ALLEN SCREW M6x75	4c	4	4c	\$1.92
6	840-866	ALLEN SCREW M6x25	4	4	4	\$1.14
7	922-242	ANGULAR TUBE 1/4-18NPT	2	2	2	\$18.14
8	956-143	TUBE 66 MM	2j	2j	2j	\$6.50
8	956-141	TUBE 81 MM	1j	1j	1j	\$8.25
8	956-142	TUBE	2i	2i	2i	\$69.43
9	924-541	COMPENSATING TUBE ASSEMBLY	1j	1j	1j	\$105.93
10	853-515	CLAMP 16/9	2	2	2	\$5.06
11	953-400	BRACKET	2	2	2	\$4.54
13	940-980	SCREW M3.5	1j	1j	1j	\$3.92
14	230-290	O-RING 44x2	2b		2b	\$8.25
14	230-300	O-RING 47x2	2c	2	2c	\$6.61
15	267-789	RUBBER FLANGE ASSEMBLY	2f	2f	2f	\$105.40
16	250-315	WASHER 8.4	4	4	4	\$0.41
17	940-481	HEX. SCREW M8x30	2j	2j		\$1.40
18	240-276	HEX. SCREW M8x25	2j	2j	4	\$1.26
19	931-640	GASKET	2e		2e	\$13.95
20	874-300	DRIP TRAY	(2g)	(2g)	2	\$102.21
21	230-415	GASKET A 6x10	2	2	2	\$1.40
22	641-071	HEX. SCREW M6x6	2	2	2	\$1.43

- Items not illustrated

- a For cylinder 2 and 4
- b From engine S/N up to engine S/N
 912 A: 4,410.169 up to 4,410.335
 912 F: 4,412.720 up to 4,412.782
 912 UL: 4,401.595 up to 4,402.978
 914 F: 4,420.011 up to 4,420.128
 914 UL: 4,417.708 up to 4,417.727
- c From engine S/N
 912 A: 4,410.336
 912 F: 4,412.783
 912 UL: 4,402.979
 914 F: 4,420.129
 914 UL: 4,417.728
- d up to engine S/N (only if the engine was not refitted with intake manifolds 867-683 and 867-688)
 912 A: 4,410.336
 912 F: 4,412.783
 912 UL: 4,402.978
 914 F: 4,420.128
 914 UL: 4,417.727
- e Only at intake manifold without O-ring
- f Following Service Bulletin has to be noticed:
 SB-912-030 letztgültige Ausgabe/current issue
 SB-914-019
- g Intended for airboxes without drip tray.
- h For rework of exhaust port
 See Maintenance Manual Heavy of the respective engine type, current issue.
- i in a roll
- j Following Service Instruction has to be noticed:
 SI-912-020 current issue
 SI-914-022
- k For cylinder 1 and 3
- l Intake manifold with connection boss for pneumatic carburetor-synchronisation.
 From engine S/N
 912 A: 4,410.420
 912 F: 4,412.808
 912 S: 4,922.624
 912 UL: 4,404.045
 912 ULS: 4,426.475
 912 ULSFR: 4,429.593
 914 F: 4,420.239
 914 UL: 4,417.956