



Installation Manual

***RockRack***

Aircraft Cockpit Rocker Switches

**AveoEngineering**™

© Aveo Engineering Group, s.r.o.  
[www.aveoengineering.com](http://www.aveoengineering.com)

The exclusive RockRack™ system from Aveo permits the pilot to build up his cockpit rockers to meet his particular needs. With numerous standard aviation-specific icons to pick from, the pilot can make just one simple cutout for whatever number of rockers he wants, starting with a single rocker up to a complete lineup, due to the unique locking "dovetail" stacking system of the switch housings as shown in this diagram:

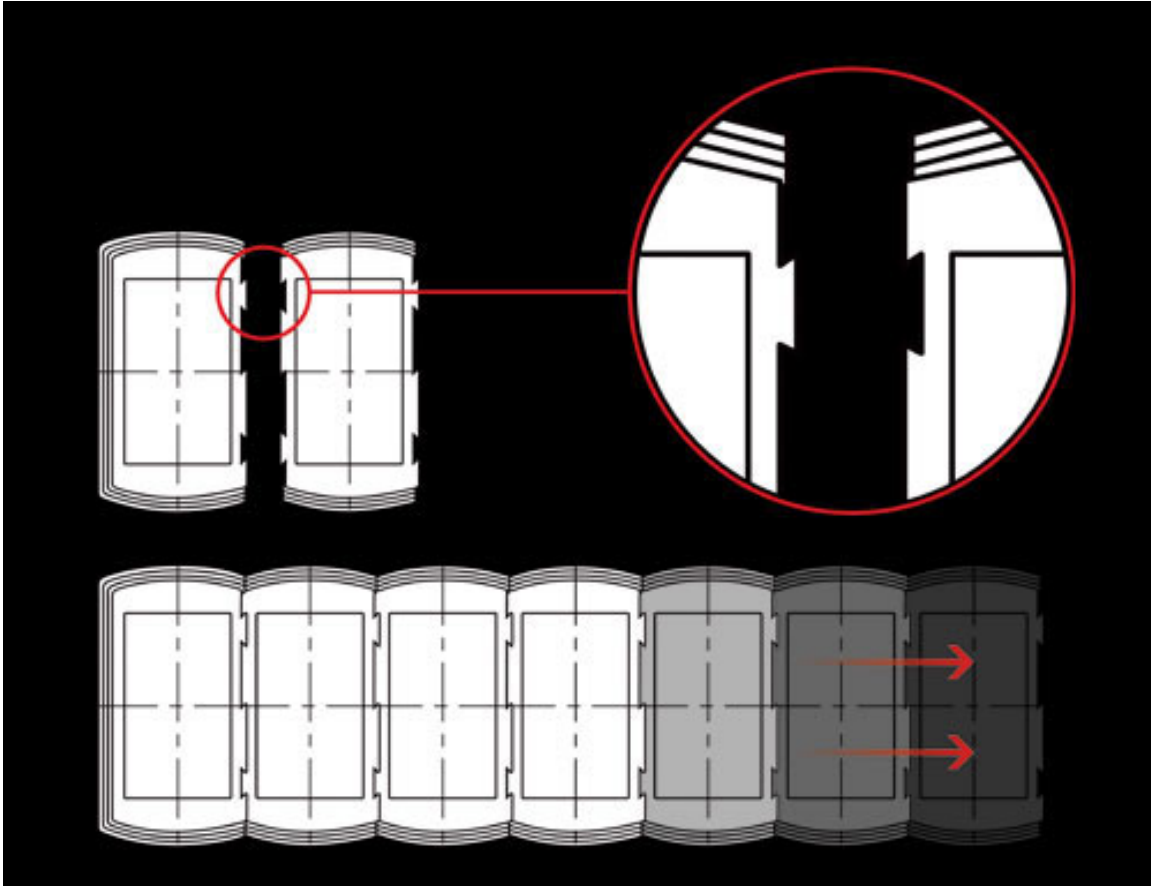

A new version of the RockRack™ is now available which features insertable lenses into single or double-window switch covers. Lenses are pre-packed like the RockRackClassic™ covers, so you can focus on the specific groups to meet your cockpit needs. With backlighting options of White, Red, Green or Blue LEDs, now you can customize your switches to meet the exact equipment of your airplane.

Now with 1, 2 and 3 position switches and also momentary switches, the RockRackClassic™ is the only total cockpit switch solution, featuring the simple nesting switches that permit just one cut-out hole convenience, and easy removal and switch cover change as you make changes to your cockpit and aircraft equipment. Backlighting options still include White, Red, Green or Blue.

---

## TECHNICAL SPECIFICATION

- 12 Volts or 24 Volts DC
- 150,000 cycles minimum mechanical life
- Water & petroleum resistant according to EN61058-1
- Tear resistant according to NF ISO 2409 Class 0
- UV resistant according to ISO 4892-2
- Silver plated contacts (gold plated contacts option)
- LED consumption: 20mA@12V at 25° C
- Meets or Exceeds All FAA & EASA Requirements

## TECHNICAL DRAWING

*End Module*

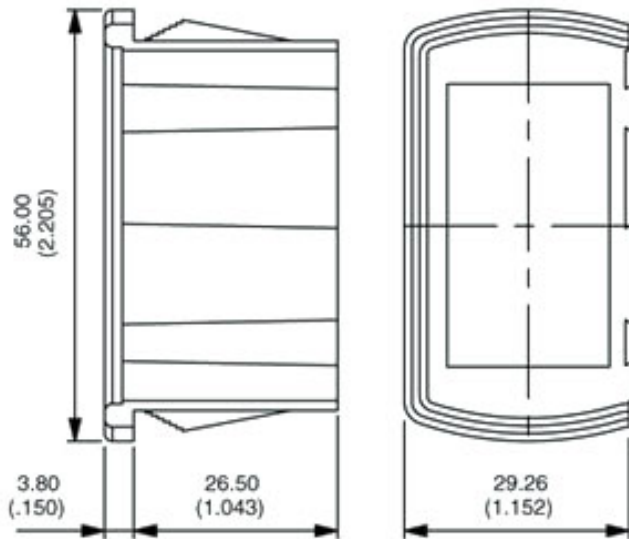

[dimensions in mm / inches]

*Middle Module*

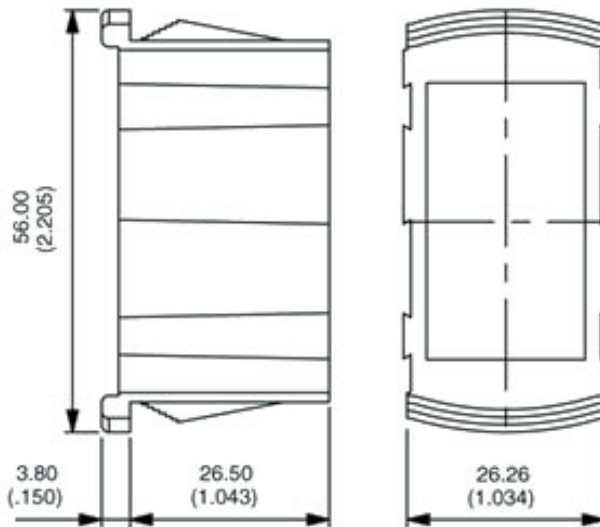

[dimensions in mm / inches]

*Single Module*

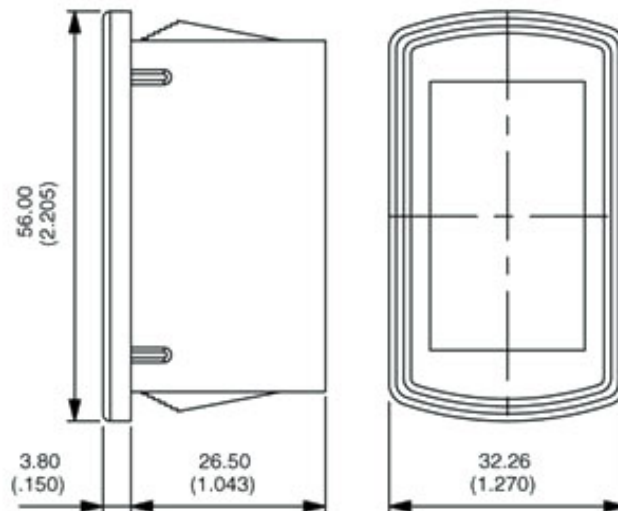

[dimensions in mm / inches]

CONNECTIONS

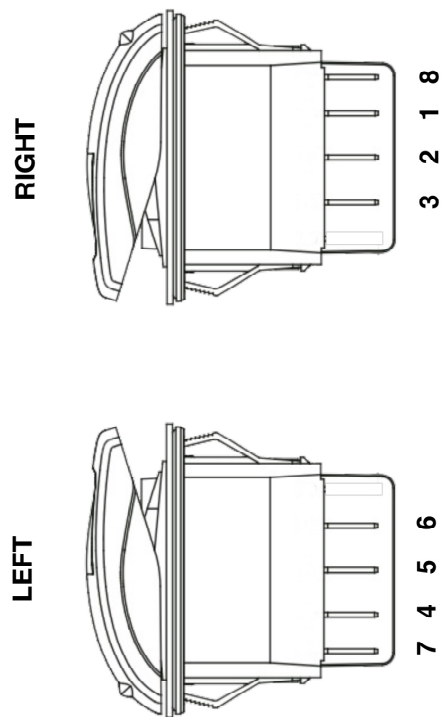

LED CONNECTION

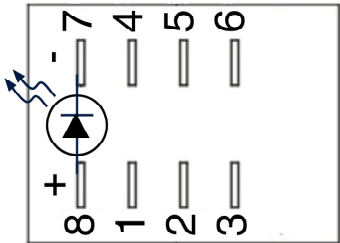

SWITCH CONNECTION

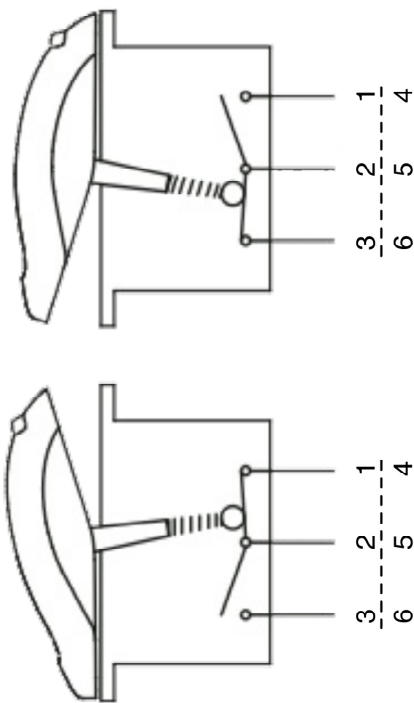

## BASE SWITCH CONNECTION

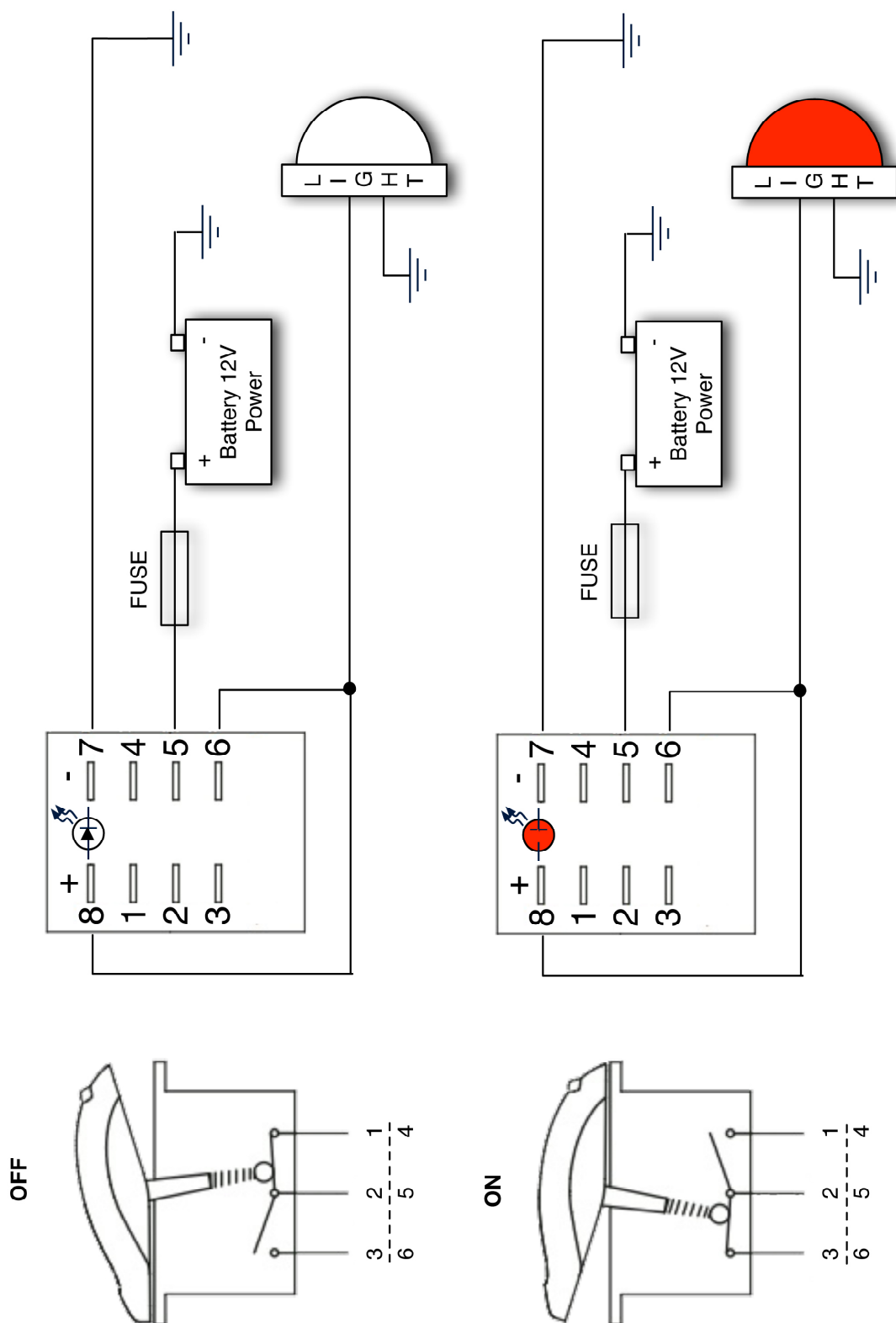

## EXTENDED SWITCH CONNECTION

