

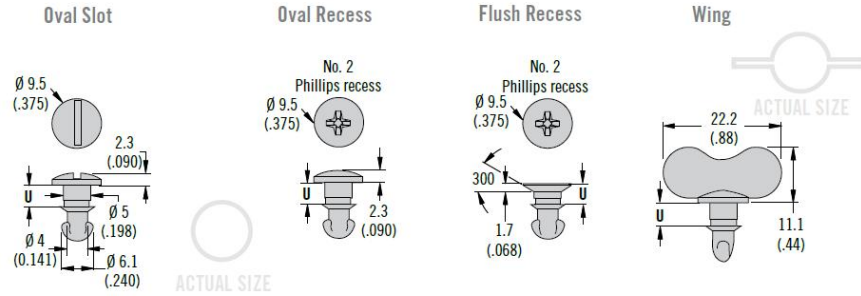

82 DZUS® Studs

H Head Styles - Tool Actuated



Stud Panel Preparation

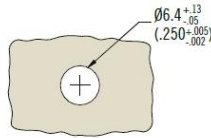

Flush Head Styles

(when outer panel is 1.3 (.050) or greater)

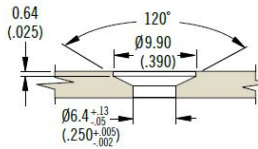

Part Number Selection

H Head style

- 11 Oval slot
- 12 Wing head
- 19 Oval Phillips recess
- 28 Flush Phillips recess

K Length

Enter number from selection table below

82 - H - K - M

M Material

- 16 Steel, zinc plated
- 20 Stainless steel (not available in tool head recess head style)

Stud Length Table					
A		D		K	U
TMT Range For: 82-35-306-10		TMT Range For: All Other Receptacles			
Min.	Max.	Min.	Max.		
0.7 (.026)	1.2 (.045)	2.3 (.090)	2.8 (.110)	100	3.2 (.127)
1.2 (.045)	1.7 (.065)	2.8 (.110)	3.3 (.130)	120	3.7 (.147)
1.7 (.065)	2.2 (.085)	3.3 (.130)	3.8 (.150)	140	4.2 (.167)
2.2 (.085)	2.7 (.105)	3.8 (.150)	4.3 (.170)	160	4.7 (.187)
2.7 (.105)	3.2 (.125)	4.3 (.170)	4.8 (.190)	180	5.3 (.207)
3.2 (.125)	3.7 (.145)	4.8 (.190)	5.3 (.210)	200	5.8 (.227)
3.7 (.145)	4.2 (.165)	5.3 (.210)	5.8 (.230)	220	6.3 (.247)
4.2 (.165)	4.7 (.185)	5.8 (.230)	6.3 (.250)	240	6.8 (.267)
4.7 (.185)	5.2 (.205)	6.4 (.250)	6.9 (.270)	260	7.3 (.287)
5.2 (.205)	5.7 (.225)	6.9 (.270)	7.4 (.290)	280	7.8 (.307)
5.7 (.225)	6.2 (.245)	7.4 (.290)	7.9 (.310)	300	8.3 (.327)
~	~	7.9 (.310)	8.4 (.330)	320	8.8 (.347)
~	~	8.4 (.330)	8.9 (.350)	340	9.3 (.367)
~	~	8.9 (.350)	9.4 (.370)	360	9.8 (.387)
~	~	9.4 (.370)	9.9 (.390)	380	10.3 (.407)
~	~	9.9 (.390)	10.4 (.410)	400	10.8 (.427)