

GASKETS – STUDS

EXHAUST MANIFOLD NUTS



Part No.	Thread Size	Type	Engine Application	Price
21247	1/4-28	Brass	Cont., E185, IO470, IO520, GTSIO520, LTSIO520, TSI0520, IO550, IOF5550, TSI0550, TSI0F550, TSI0L550	\$3.80
22022	5/16-24	Brass	Continental: A-65, C-75 thru C-90, O-200, O-300	\$1.30
STD1410	5/16-18	Steel	Lycoming	\$1.65

GASCOLATOR GASKETS



Gascolator Gasket, Manufactured from fuel resistant "Buna Rubber" material.

Description	Part Number	Price
2-1/4" OD. x 1-3/4" ID x 1/16" Buna and Cork material	05-11188	\$9.65
2" OD. x 1-3/8" ID x 1/8" Buna Rubber material	05-11190	\$3.65
2-1/8" OD. x 1-1/2" ID x 1/8" Buna Rubber material	05-11189	\$7.95
2-1/4" OD. x 1-3/8" ID x 1/8" Buna Rubber material	05-11187	\$2.65
2-1/4" OD. x 1-3/8" ID x 3/16" Buna Rubber material	05-11191	\$8.80

OIL COOLER GASKET SETS

Our P/N	Continental P/N	Price ea.
08-76510	76510	\$1.95

BLO-PROOF EXHAUST GASKETS



These gaskets are manufactured in a 1-piece design in 7/64" thick steel. They have a split metal inner ring which provides an absolute seal and they are guaranteed not to blow off. Engine manufacturer's parts.

Continental P/N 627429 for all A, C and E Series **\$8.50 Ea**
 Continental P/N 628260 for O-470-R. **\$11.50 Ea**
 Lycoming P/N 77611 for 4 & 6 Cylinder Engines..... **\$8.80 Ea**

EXHAUST GASKETS



Continental P/N 21493 (now P/N 632837 stainless steel)

Cont.#21493 for A-65 to O-300.....P/N 08-05237 **\$1.65 Ea**
 Cont. #632837 Stainless Steel.....P/N 08-13232 **\$1.93 Ea**
 Lycoming O-320 except h seriesP/N 77611 **\$8.80 Ea**

AIRBORNE BLO-PROOF GASKETS



Side view
Cross Section



2 gaskets used per cylinder, with raised beads interlocked facing the exhaust stack flange. Eight required for 4 cyl. engine, 12 for 6 cyl. engine.

Engine Model Number	Airborne P/N (Use 2/ Cyl.)	Price Each
All Lycoming Engines except IO-540-B,-E,-M,-WD,IGO-540-B,IGSO-540-B,TIO-540 series,TIO-541 series TIGO-541 series, IO-540-B,-E,-M,-WD,IGO-540-B,IGSO-540-B	160	\$46.50
TIO-540 Series, TIO-541 Series, TIGO-541 Series	161	\$13.30

STEEL EXHAUST STACK FLANGES



Cont. A&C Series,O-200,O-300.....P/N 33011 **\$13.50 Ea**
 Lycoming O-235 to O-540P/N 33021 **\$13.50 Ea**

STAINLESS STEEL

Continental A & C SeriesP/N 33101 **\$17.50 Ea**
 Continental IO-470 thru IO-520.....P/N 33103 **\$17.50 Ea**
 Lycoming O-235 thru IO-360P/N 33102 **\$16.50 Ea**
 Lycoming IO-540P/N 33104 **\$17.50 Ea**

LYCOMING STUDS

Description	Part No.	Price
25-22 Lycoming Stud-.250-20 X 2.75 LONG	07-18027	\$121.75
25-8 Lycoming Stud-.250-20 X 1.00 LONG	07-14785	\$17.95
25-8-P03 Lycoming Stud-.250-20 X 1.00 LONG	07-14786	\$63.75
25C-10 Lycoming Stud-.250-20 X 1.25 LONG	07-14787	\$11.85
25C-10-P03 Lycoming Stud-.250-20 X 1.25 LONG	07-14788	\$15.95
25C-10-P07 Lycoming Stud-.250-20 X 1.25 LONG	07-14789	\$501.00
25C-11 Lycoming Stud-.250-20 X 1.38 LONG	07-14790	\$12.50
25C-11-P03 Lycoming Stud-.250-20 X 1.38 LONG	07-14791	\$54.75
25C-11-P07 Lycoming Stud-.250-20 X 1.38 LONG	07-14792	\$34.50
25C-12 Lycoming Stud-.250-20 X 1.50 LONG	07-14793	\$21.65
25C-12-P03 Lycoming Stud-.250-20 X 1.50 LONG	07-14794	\$29.55
25C-14 Lycoming Stud-.250-20 X 1.75 LONG	07-14795	\$8.45
25C-14-P03 Lycoming Stud-.250-20 X 1.75 LONG	07-14796	\$97.75
25C-14-P12 Lycoming Stud-.250-20 X 1.75 LONG	07-14797	\$63.75
25C-16 Lycoming Stud-.250-20 X 2.00 LONG	07-14798	\$96.75
25C-18 Lycoming Stud-.250-20 X 2.25 LONG	07-14799	\$206.95
25C-19 Lycoming Stud-.250-20 X 2.38 LONG	07-14800	\$10.80
25C-19-P03 Lycoming Stud-.250-20 X 2.38 LONG	07-14801	\$116.85
25C-20 Lycoming Stud-.250-20 X 2.50 LONG	07-14802	\$52.75
25C-21 Lycoming Stud-.250-20 X 2.63 LONG	07-14803	\$21.55
25C-21-P03 Lycoming Stud-.250-20 X 2.63 LONG	07-14804	\$139.90
25C-22 Lycoming Stud-.250-20 X 2.75 LONG	07-14805	\$15.70
25C-22-P03 Lycoming Stud-.250-20 X 2.75 LONG	07-14806	\$80.75
25C-22-P07 Lycoming Stud-.250-20 X 2.78 LONG	07-14807	\$139.75
25C-24 Lycoming Stud-.250-20 X 3.00 LONG	07-14808	\$48.75
25C-29 Lycoming Stud-.250-20 X 3.63 LONG	07-14809	\$78.95
25C-31 Lycoming Stud-.250-20 X 3.88 LONG	07-14810	\$38.50

EXHAUST STUDS FOR CONTINENTAL ENGINES



These high quality exhaust/engine studs produced from corrosion resistant 321 stainless steel in 5/16-18" X 5/16-24" standard thread size are a direct replacement for the TCM Continental part number 402-151 stud. FAA/PMA approved for the Continental engines C-75, C-85, C-90, O-200 series engines, and o-300 (early) series engines.

P/N 08-07282 **\$9.85**
 Stud for Continental Engines O-470, IO-470 (1/4"x20-1/4"x28)
 P/N 08-07281 **\$8.85**

STAINLESS STEEL EXHAUST STUDS FOR LYCOMING ENGINES



Produced from corrosion resistant 321 in 5/16 x 18 standard thread size and are a direct replacement for the Lycoming part number 31C12 stud. Stop stud corrosion and rust out problems, stop expensive cylinder repair costs cause by broken studs, allow easy removal of exhaust systems for gasket replacement or inspection, but does not feature a safety wire hole (refer to p/n 08-06780 for safety wire hole feature). FAA approved for all Lycoming engines from O-235 through O-540.

CAD Plated Steel with out Safety Wire Hole P/N 08-06279..... **\$5.60**
 Stainless Steel With safety wire hole feature P/N 08-06780..... **\$11.50**

STA-FLATZ INTAKE CLAMP

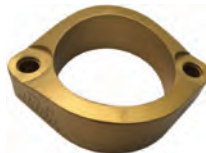

Machined from billet 6061 aluminum and finished with gold anodize. This will reduce your chance of induction leaks, especially turbo charged engines! Experimental only. Not FAA approved. P/N 08-13906 **\$42.65**

EP