

BEARINGS REGREASERS – GREASE FITTINGS

DW SERIES BEARINGS (MS 27647)

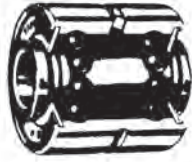

- Extra Wide, Double Row, Ball
- Equipped with removable Plya-Seals
- Dimensionally interchangeable with the DW series, the GDW series is lubricatable through holes and a groove in the outer ring.

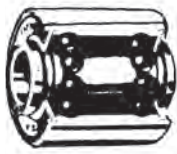
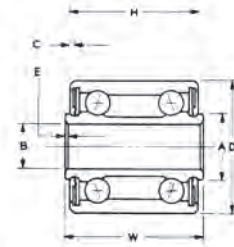

FAFNIR AND MS AFB MA Bearing No.	Bore 27647	B		D		W		H		A		E		C		Balls		Pure Moment Rating Inch-Lbs.	Moment Constant 1 Inch	Weight Pounds (Approx.)	Price Each
		Diameter +.0000 - .0005 Inches	Outside Inner Ring +.0000 - .0005 Inches	Width Outer Ring +.000 - .005 Inches	Width Inner +.000 - .005 Inches	Shoulder Width Bore Ring (Approx.) Inches	Corner Chamfer x 45° Inner Ring +.015 - .000 Inches	Outer Ring +.015 - .000 Inches	No.	Size											
† DW4K2*	-4A	.2500	.6250	.562	.500	.344	.016	.016	16	3/32"	121	3.49	.025	\$36.50							
DW4K*	-4	.2500	.7500	.875	.750	.435	.005	.016	14	9/64"	365	2.27	.04	\$34.95							
DW5	-5	.3125	.8750	.9375	.8125	.472	.005	.016	26	9/64"	830	1.85	.07	\$44.65							
DW6	-6	.3750	1.0625	1.1875	1.0625	.576	.005	.016	24	3/16"	1830	1.38	.12	\$69.85							
DW8	-8	.5000	1.4375	1.5000	1.3750	.715	.005	.032	22	17/64"	4330	1.07	.29	\$71.25							

EQUIVALENT THRUST LOAD = THRUST + .6 RADIAL LOAD + MOMENT CONSTANT x MOMENT IN INCH-LBS.

*Bearing stamped DW4K. †Bearing stamped DW4K2.

These bearings are not to be used as track rollers, cam follower rolls and the like.

* RETAINER TYPE

AP

SINGLE ROW, BALL, DOUBLE SEATS



KP3AR11-2



K3L3



K3L2

FAFNIR AND AFBMA Bearing Number	B		D		W		H		A		E		C		R		Balls		Maximum Safe Working Load Radial Lbs.	Weight Pounds (Approx)	Price Each
	Bore +.0000 - .0005 Inches	Outside Diameter +.000 - .002 Inches	Width Inner Ring +.000 - .005 Inches	Width Outer Ring +.000 - .005 Inches	Shoulder Diameter Inner Ring (Approx.) Inches	Corner Chamfer x 45° Inner Ring Bore +.015 - .000 Inches	Corner Outer Ring O.D. Inches	Radius Outside Diameter Contour	No.	Size											
K3L3	.1900	.635	.245	.203	.280	.005	.020 Rad.	.550	10	1/8"	200	.01	---								
K3LR48	.1900	.687	.245	.203	.280	.005	.020 Rad.	3.015	11	5/32"	200	.20	---								
							.015 Rad.	2.985													
KP4R16	.2500	.901	.484	.335	.390	.005	.005 x 45°	1.000	11	5/32"	400	.04	\$139.75								
KP4R16-2	.2500	1.000	.390	.335	.390	.005	.015 x 45°	1.000	11	5/32"	500	.06	\$49.90								
							.015 x 45°	.990													

The maximum safe working load is that radial load to obtain 100,000 feet peripheral travel life.

GREASE FITTINGS

Surface Check fittings of the MS15000 series have spring-loaded ball check in the tip. Conform to MIL-F-3541.



MS No.	AS No.	Price	Surplus No.	Price	Thread	Shank L	Eff. Thread L	Overall L	Tip Angle
MS15001-1	AS15001-1P	\$3.65	04-02325	\$0.25	1/4-28 Tapered	3/16"	.109	1/2"	0°
MS15001-2	AS15001-2P	\$4.50	04-02326	\$0.70	1/4-28 Tapered	5/8"	.20	31/32"	0°
MS15001-3	AS15001-3P	\$5.35	04-02327	\$0.76	1/4-28 Tapered	13/64"	.11	13/16"	45°
MS15001-4	AS15001-4P	\$4.75	04-02313	\$0.75	1/4-28 Tapered	3/16"	.109	1/2"	90°
MS15002-1	AS15002-1P	\$3.35	04-02328	\$0.45	1/4-28 Tapered	5/32"	.07	33/64"	0°
MS15002-3	AS15002-3P	\$7.50	04-02329	---	1/4-28 Tapered	1/8"	.07	39/64"	45°
MS15003-1	AS15003-1P	\$4.80	04-02330	\$0.40	1/8 NPT	19/64"	.19	11/16"	0°
MS15003-2	AS15003-2P	\$5.50	04-02331	\$1.25	1/8 NPT	25/32"	.19	1-1/4"	0°
MS15003-3	AS15003-3P	\$5.70	04-02332	\$1.35	1/8 NPT	19/64"	.19	29/32"	30°
MS15003-4	AS15003-4P	\$5.35	04-02333	\$1.58	1/8 NPT	19/64"	.19	57/64"	45°
MS15003-5	AS15003-5P	\$4.55	04-02315	\$0.67	1/8 NPT	9/32"	.188	31/32"	65°
MS15003-6	AS15003-6P	\$4.70	04-02314	\$0.83	1/8 NPT	9/32"	.188	15/16"	90°

ACS BEARING REGREASERS

The ACS bearing regreasers restore bearings, rod ends and pulleys to like-new condition. O-ring in base of regreaser provides positive seal when bearing is secured by the threaded center post. Grease, entering under pressure at the grease fitting, is forced to flow through the bearing, flushing out the old grease and dirt, and recharging the bearing with fresh grease. Available in five sizes. Non-Anodized.

Bearing Regreaser No.	Part No.	Bearing Size		Price Each
		O.D.	Bore	
3	10650-3	3/4"	3/16"	\$16.65
4	10650-4	1"	1/4"	\$19.85
5	10650-5	1-1/4"	5/16"	\$20.80
6	10650-6	1-1/2"	3/8"	\$21.75
8	10650-8	1-1/2"	1/2"	\$27.85
Complete Set of Five - P/N 12-11500				\$105.95

LUBRICAPS



These bright red Lubricaps are made of molded rubber and are used as grease fitting covers. The internal lip holds the cap in place and keeps out dirt, sand, and fluids. M-24529 (20% discount for 100/each)P/N 04-01940\$0.67