

SPECIALTY TOOLS



GO-NO GO SLEEVE GAUGE

When the proper slot in the gauge slips over the compressed area of the sleeve after swaging then your swage is satisfactory. GA-1P: Gauges all swages performed on 1/32", 3/64", 1/16" 3/32", 1/8", 5/32", and 3/16" oval and stop sleeves.

P/N GA-1P.....\$12.80



NO-GO GAGE

There are five measurements required for each pilot and co-pilot seat, these two tools will shorten the time to make these five measurements to minutes.

P/N 12-02861.....\$39.95



COMPASS FILLING AID

The compass filling aid is designed to be used for filling most standard aircraft compasses. The standpipe is simply attached to the compass with a supplied special rubber band. The compass is then filled and purged through the standpipe. When all air is removed, and the level in the standpipe is constant, the plug is then installed through the filled standpipe. Thus the need for submerging for proper filling is eliminated.

P/N 12-17604.....\$23.50

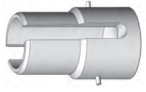

VENTURI REMOVING TOOL

Venturi extractor tool used on Marvel-Schebler®, MA-3® and MA-4® series carburetors.

P/N 12-01908.....\$255.95



THE PEN GRIP - PEN AND TOOL HOLDER

The Pen Grip attaches to almost any surface with double stick tape. Just peel off the backing on the attached double stick adhesive, press firmly onto the surface to which you want it attached and insert your tools. The unique gripping fingers hold all sorts of pens, pencils, & tools in many different positions, even upside down. Like the Tool Grip, The Pen Grip is available in White and Black.

Get a Grip Pen Grip (Black).....PN 12-00961.....\$5.95

Get a Grip Pen Grip (White).....PN 12-00962.....\$5.95

WIRE SPOON



Features: • Wire threader designed for threading wires into an already tied harness • 300 Series stainless steel construction • Made in America for superior quality.

P/N 12-01801.....\$8.50

FELCO CABLE CUTTERS



A cable when crushed or deformed is difficult to use with fittings. These fine quality Swiss made cutters, with unique triangular jaws, never leave a frayed end.

Felco No.	Max Cutting Dia.	Length	Weight	PN	Price
C2A	2mm	8"	.625 lbs	12-00223	\$66.75
C7F	3/16"	8"	.625 lbs	12-01135	\$56.90
C9	1/4"	13"	1.6 lbs	12-00179	\$162.75
C12	3/8"	19"	3 lbs	12-01174	\$244.95
C16	5/8"	22"	5 lbs	12-05133	\$347.00

S & F CABLE CUTTERS



A fine tool made from high quality alloy steel and heat treated for best cutting action and long life of cutting edges. Handles shaped for comfortable grip and minimum cutting effort. Max. capacity 3/16" dia. 1 x 19 cable.

No. 316 Cable Cutter.....P/N 12-18600.....\$19.50

BENCH MOUNT FOR #316 CABLE CUTTER

This bench mount adds to the versatility of the #316 cable cutter. Mounts with 2 screws to a bench or plate. Fingers can still grip the tool. Easily removed.

P/N 12-00674.....\$3.50

S & F HARD WIRE CUTTER



These quality cutters feature a unique handle design with thick "T" shaped vinyl handle grips for maximum comfort while cutting. Cuts 3/32" maximum diameter music wire, heat treated steel spring wire, stainless or galvanized cable. Produces clean square cuts.

Gold iridite finish for maximum rust protection. Length: 6". Wt. 7 oz. Model No. 093.....P/N 12-18605.....\$17.95



1/4 INCH AIR DIE GRINDER - VT3000

- 1/4" Air Die Grinder - VT3000
- Lightweight - powerful compact design
- VT3000- 25,000 RPM
- All ball bearing construction for longer tool life
- Self-locking safety throttle lever to prevent accidental starts
- Ergonomic positive grip
- Rear exhaust.....P/N 12-02550.....\$39.85



1/4 INCH AIR DIE GRINDER - VT3000A

- 1/4" Angle Type Air Die Grinder VT3000A
- Lightweight - powerful compact design
- All ball bearing construction for longer tool life
- Self-locking safety throttle lever to prevent accidental starts
- Ergonomic positive grip
- Rear exhaust.....P/N 12-02551.....\$89.75



1/4 INCH AIR DIE GRINDER - VT3001A

- 105° angle type head
- Direct drive - no bevel and pinon gears to maintain
- One piece casting
- Ergonomic design for operator convenience
- Safety throttle lever
- Rear exhaust.....P/N 12-02553.....\$96.75

DILLON MECHANICAL FORCE GAUGE



Model X-C comes in nine capacities ranging from 50 lb to 25,000 lb or 50 to 10000 kg. Allfeature accuracy of ±1% of full capacity, except the 25,000 (10000kg) capacity instruments which are accurate to ±2% of full capacity.

Load is applied against a hardened ball which rotates to maintain vertical alignment as pressure increases. The ball is held in place with a spring clip or retainer. A threaded mounting hole is located opposite the loading ball in the bottom of the beam. Model X-C is available in pound and kilogram capacities.

P/N 12-03326.....\$820.00

DZUS SNOOPY TOOL



Classic tool designed for Dzus fasteners found on warbird and antique airplanes. Tool matches the most common size slots in 1/4 turn fasteners, giving the tool the distinctive "snoopy" shape. This tool is made from heat treated 4130 aircraft steel, with a riveted wooden handle – exact copy of the original tools. Made in the USA.....P/N 12-04763.....\$21.50

AN VISE JAWS



Generally AN Vise Grips are cheap castings that lack the precision mating surfaces necessary to avoid unsightly tool marks on your fresh hose assemblies. This is especially true with black anodized fittings so prevalent today. Get rid of your old vise jaws and stop using the sharpie to cover mistakes.....P/N 04-03665.....\$25.50

QUICK-CHECK TENSION METERS



The Dillon Quick-Check can be placed on a cable, measure its tension, and removed in under five seconds! There are no complex lookup tables, no conversion charts. The operator can quickly select from 15 different wire sizes and types stored in Quick-Check's memory. The Check-Tensioning mode graphically displays the current and target tensions for extremely quick setting of line tension. Even the infrequent battery changes are quick. The Quick-Check can be employed in many industries to ensure proper tensioning. Typical applications include tower and stack guy wires, pretensioned cable barriers, bridges, elevators, winch rope, overhead electric transit wires, fall arrest systems, aircraft cables and utilities. **Features:** • Sheaves with bearings eliminate friction and provide the best accuracy • Accommodates a wide range of wire sizes and styles • Telescoping handle engages meter quickly with minimal effort • Highly visible yellow finish • Easy-to-read display with full-text prompts • Easy to use soft-key interface • Uses popular AA batteries and has long life between changes.

2000 Lb.PN 12-03324.....\$2,632.00
10000 Lb.PN 12-03325.....\$3,598.00

TO