

WHEELS & BRAKES

FAA-APPROVED CLEVELAND WHEELS & BRAKES

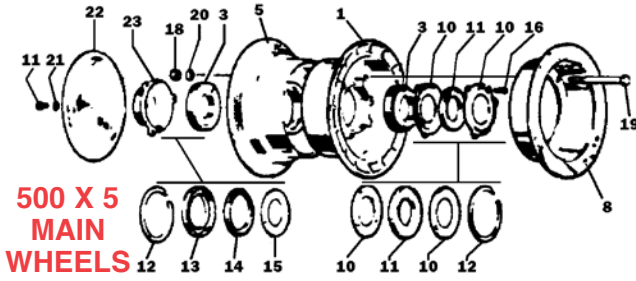

**500 X 5
MAIN
WHEELS**

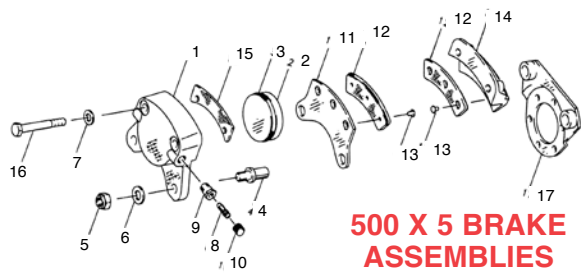

**500 X 5 BRAKE
ASSEMBLIES**

FIG	Cleveland P/N	Part No.	Description	Assembly Number	Qty. Per Assembly						Price Each	
					40-12	40-12A	40-12B	40-19	40-19A	40-19B		40-78
1	161-5	161-00500	Inner Wheel Half Assy.	1	1	1						\$1,204.00
	161-03100	161-03100	Inner Wheel Half Assy.							1		\$589.00
	161-04100	161-04100	Inner Wheel Half Assy.							1		\$705.00
3	08231	214-00300	Cup-Bearing	1	1	1	1	1	1	1	1	\$34.65
5	162-00500	162-00500	Outer Wheel Half Assy.	1	1	1						\$1,153.00
	162-02800	162-02800	Outer Wheel Half Assy.							1		\$786.00
3	08231	214-00300	Cup-Bearing	1	1	1	1	1	1	1	1	\$34.65
*	217-00100	217-00100	Grommet							1	1	\$10.75
*	101-07200	101-07200	"O" Ring	1	1	1						\$321.00
8	164-00400	164-00400	Brake Disc Assy.	1	1	1	1	1	1			\$323.00
	164-17	164-01700	Brake Disc Assy.							1	1	\$199.75
*	08125	214-00400	Cone-Bearing	2	2	2	2	2	2	2	2	\$62.75
19	AN4-31A	103-10800	Bolt	3	3	3	3	3	3			\$0.84
	AN4-22A	103-10500	Bolt							3	3	\$0.61
20	AN960-416	095-10400	Washer	6	6	6	6	6	6	3	3	\$0.04
18	AN365-428A	094-10300	Nut	3	3	3	3	3	3	3	3	\$0.15
10	153-00800	153-00800	Ring-Grease Seal	2	2	4	2	2	4	4	4	\$19.95
12	155-00200	155-00200	Ring-Snap	2	2	2	2	2	2	2	2	\$24.50
11	154-00600	154-00600	Felt-Grease Seal	1	1	2	1	1	2	2	2	\$13.75
23	158-00500	158-00500	Cap-Hub	1	1	1	1					\$391.00
17	102-25100	102-25100	Screw	1	1	1	1	1				\$18.80
21	095-15400	095-15400	Washer-Lock	1	1	1	1	1				\$11.70
22	157-00500	157-00500	Shield-Dust	1		1						\$153.75

MODEL NO. 05-13459 wheel with brake disc and 1-1/4" dia. bearings as used on Cessna 150.....P/N 05-13459.....\$2,317.00

MODEL NO. 40-78B.....P/N 40-78B.....\$1,895.00

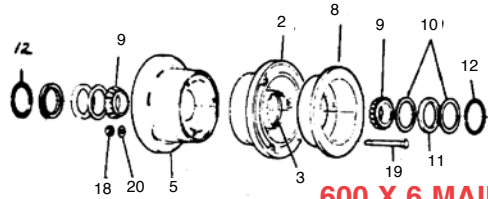

600 X 6 MAIN WHEELS

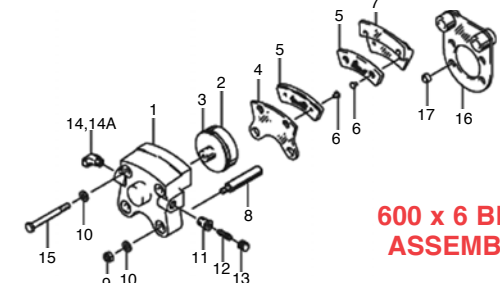

**600 X 6 BRAKE
ASSEMBLIES**

FIG	Cleveland P/N	Part Number	Description	Assembly Number	Qty. Per Assembly						Price Ea.
					40-97	40-97A	40-97B	40-97C	40-97D	40-99	
2	161-03000	161-03000	Inner Wheel Half Assy.	1	1	1	1	1	1	1	\$417.00
	161-02100	161-02100	Inner Wheel Half Assy.							1	\$991.00
3	13836	214-00100	Cup-Bearing	1	1	1	1	1	1	1	\$38.70
5	162-02700	162-02700	Outer Wheel Half Assy.	1	1	1	1	1	1	1	\$464.00
	162-01900	162-01900	Outer Wheel Half Assy.							1	\$1,309.00
	13836	214-00100	Cup-Bearing	1	1	1	1	1	1	1	\$38.70
8	164-26A	164-02601	Brake Disc Assy.	1	1	1	1	1	1	1	\$159.75
	164-02800	164-02800	Brake Disc Assy.							1	\$254.95
9	214-00200	214-00200	Cone-Bearing	2	2	2	2	2	2	2	\$138.85
19	AN5-35A	103-20400	Bolt	3	3	3	3	3	3		\$1.38
	AN4-37A	103-11200	Bolt							6	\$1.32
20	AN960-516	095-10500	Washer	3	3	3	3	3	3		\$0.04
	AN960-416L	095-10200	Washer							6	\$0.02
18	AN365-524A	094-10400	Nut	3	3	3	3	3	3		\$0.20
	AN365-428A	094-10300	Nut							6	\$0.15
10	153-00400	153-00400	Ring-Grease Seal	2	2		2	2	2	2	\$19.95
	153-00300	153-00300	Ring-Grease Seal	1	1	2	1	1			\$16.85
	153-01500	153-01500	Ring-Grease Seal	1	1	2	1	1			\$25.50
	158-00300	158-00300	Cap-Hub							1	\$79.75
11	154-00300	154-00300	Felt-Grease Seal	1	1	1	1	1	1	1	\$12.45
	154-01300	154-01300	Felt-Grease Seal	1	1	2	1	1			\$11.85
12	155-00100	155-00100	Ring Snap	2	2	2	2	2	2	2	\$13.50
	154-12400	06-01778	Molded Grease Seal							1	\$32.50
	154-12000	06-01782	Molded Grease Seal							1	\$37.85

MODEL NO. 40-97A wheel with brake disc and 1.5" dia. bearings fits Cessna 172, 182.....P/N 40-97A.....\$1,020.00

FIG	Cleveland P/N	Part No.	Description	Assembly Number	Qty. Per Assembly					Price Each	
					30-9	30-9A(2)	30-9C	30-9D	30181A		
	91-00702	06-01203	Cylinder Assembly	1	1	1	1	1		\$639.00	
	91-04800	06-01204	Cylinder Assembly		1	1	1	1		\$1,365.00	
	91-17401	06-01205	Cylinder Assembly						1	\$950.00	
1	61-00601	061-00601	Cylinder	1					1	\$539.00	
	61-03901	061-03901	Cylinder		1	1	1	1		---	
	92-00200	06-01206	Piston	1	1	1	1	1	1	\$145.00	
2	79-00300	062-00300	Piston	1	1	1	1	1	1	\$128.75	
3	101-02300	AN6227B-23	O-ring (MS28775-218)	1	1	1	1	1	1	\$1.02	
4	069-00400	069-00400	Anchor bolt	2	2	2	2	2	2	\$36.95	
5	94-10300	AN365-428A	Nut (MS21044-N4)	2	2	2	2	2	2	\$0.15	
6	95-10400	095-10400	Washer (AN960-4-16)	2	2	2	2	2	2	\$0.04	
7	95-10200	095-10200	Washer (AN960-416L)	2	2	2	2	2	2	\$0.02	
8	079-00300	079-00300	Screw-Bleeder	1	1	1	1	1	1	\$17.70	
9	081-00100	081-00100	Seat-Bleeder	1	1	1	1	1	1	\$28.60	
10	183-00100	183-00100	Cap-Bleeder	1	1	1	1	1	1	\$6.50	
	073-00300	073-00300	Pressure Plate Assy.	1	1	1	1	1	1	\$215.00	
11	063-00500	063-00500	Pressure Plate	1	1	1	1	1	1	\$176.75	
12	066-10600	066-10600	Lining	1	1	1	1	1	1	\$14.50	
13	15-00200	105-00200	Rivet	3	3	3	3	3	3	---	
	074-00200	074-00200	Back Plate Assembly	1	1	1	1	1	1	\$266.95	
14	064-00500	064-00500	Back Plate	1	1	1	1	1	1	\$154.75	
12	66-106	066-10600	Lining	1	1	1	1	1	1	\$14.50	
13	15-00200	105-00200	Rivet	3	3	3	3	3	3	---	
15	68-00401	06-01196	Shim	1	1	1	1	1	1	\$366.00	
16	06-00111	103-12100	Bolt	2	2	2	2	2	2	\$0.97	
		103-11500	Bolt							2	---
17	075-00800	075-00800	Torque Plate Assembly	1	1	1	1	1	1	\$384.00	
	75-19300	06-01201	Torque Plate Assembly						1	\$738.00	

MODEL NO. 30-9 used with wheel 40-78..P/N 30-9.....\$729.00

FIG	Part No.	Cleveland No.	Description	Assembly No. & qty. per assembly					Price	
				30-56	30-56A	30-63	30-63A	30-63D		
	091-02200	091-02200	Cylinder Assy.	--	--	1	1	1	1	\$887.00
1	061-01900	061-01900	Cylinder	1	1	1	1	1	1	\$397.00
2	062-01600	062-01600	Piston	1	1	1	1	1	1	\$99.85
3	101-05200	101-05200	"O" Ring	1	1	1	1	1	1	---
	073-01100	073-01100	Press. Plate Assy.	1	1	1	1	1	1	\$128.75
4	063-01200	063-01200	Plate-Press.	1	1	1	1	1	1	\$109.75
5	66-105	66-155	Lining	1	1	1	1	1	1	\$16.25
6	105-00200	105-00200	Rivet - Cleveland 9/32" Long	2	2	2	2	2	2	\$0.75
	074-01000	074-01000	Back Plate Assy.	1	1	1	1	1	1	\$198.75
7	064-01500	064-01500	Plate-Back	1	1	1	1	1	1	\$124.75
8	069-00400	069-00400	Bolt-Anchor	2	2	2	2	2	2	\$36.95
9	AN365-428A	094-10300	Nut	2	2	2	2	2	2	\$0.15
10	AN960-416L	095-10200	Washer	4	4	4	4	4	4	\$0.02
11	081-00100	081-00100	Seat-Bleeder	1	1	1	1	1	1	\$28.60
12	079-00300	079-00300	Screw Bleeder	1	1	1	1	1	1	\$17.70
13	183-00100	183-00100	Cap-Bleeder	1	1	1	1	1	1	\$6.50
14	AN823-4D	104-00500	Fitting Tube	1	1	--	--	--	--	\$13.50
15	LP4-17AM	103-11600	Bolt-Lock	2	2	2	2	2	2	\$0.97
16	075-03700	075-03700	Torque Plate Assy.	--	1	1	1	1	1	\$389.00
17	145-01000	145-01000	Bushing	2	--	2	2	2	2	\$33.50

MODEL No. 30-63A used with wheel 40-97A..P/N 30-63A.....\$755.00

MODEL No. 30-52 Brake Assy.....P/N 30-52.....\$1,045.00

MODEL No. 30-52N Brake Assy.....P/N 06-00106.....\$1,119.00

LG