

HUB CAPS – BLACK MAX – GOODRICH

METAL HUB CAPS



These FAA approved metal hub caps are designed for older Pipers using the 800x4 Goodrich (Hayes) brakes such as the J-3 and PA-18. A larger cap for 600 x 6 conversions are also available below. The caps are available with "CUB" stamped in raised letters or plain.

- Cub 800x4 Goodrich hub capP/N 06-00010**\$41.85 ea.**
(Identical in size and appearance to Cleveland #157-9)
- Cub 600x6 Cleveland hub capP/N 06-00020**\$39.50 ea.**
- Plain 800x4 Goodrich hub capP/N 06-00030**\$32.55 ea.**
- Plain 600x6 Cleveland hub capP/N 06-00040**\$36.50 ea.**

GROVE HUB CAPS



GROVE HUB CAP 5"

For Grove, Cleveland and Gerdes wheels. Includes mounting screws. 011-012
P/N 06-01363 **\$26.50**



GROVE HUB CAP 6"

For Grove, Cleveland and Gerdes 600x6 wheels. Includes mounting screws. 011-013
P/N 06-00845 **\$29.50**



157-8

WHEEL COVERS

For Gerdes, McCauley, Cleveland, Hayes, Goodyear, Rosenhan and Matco wheels as listed. Furnished with mounting screws and lock washers.

Part No.	Wheel Size	Application	Price ea.
157-8	5.00-5*	Cleveland, McCauley, Gerdes	\$238.95
157-9	6.00-6**	Cleveland, McCauley, Gerdes	\$166.95
06-03705	6.00-6	All Goodyear Wheels	\$52.75
06-03900	5" Dia.	Rosenhan Matco Wheels	\$11.50



ECONOMY WHEEL COVER

For 600-6 Cleveland wheels
P/N 06-03710 **\$19.75 ea.**
For 500-5 Cleveland wheels
P/N 06-00073 **\$23.75 ea.**

Furnished with screws for installation

BX-1000 BLACK MAX HYDRAULIC BRAKE SYSTEM

(Everything you need in one package)

This system has a full floating rotor which compensates for alignment giving you a smooth feeling brake action. The master cylinder has a built in reservoir which allows you to add oil and bleed from the top down. Maximum holding pressure to allow for a good run up. Uses standard brake fluid. Gross rating 1000 lbs. **Rims Included.**

Features:

- Master Cylinder w/reservoir and brake handle • 2 - 6" polished aluminum wheels • 2 - Hubs w/bearings • 2 - Tires • 2 - Rotors • 2 - Calipers • 5/8" axle with keyway • Brake Pads • 14' of Hydraulic Brake Line • Fittings and Hardware.



Part No.	Model	Rim Type	Rim Size	Gross Weight	Includes tires	Axle Size	Part No.	Price
BX44708	BX1000	WELDED	4"W X 6" D	1000LBS	YES	5/8" X 8"	06-00707	\$499.00
BX44708-4	BX1000	WELDED	4"W X 6" D	1000LBS	YES	5/8" X 8"	06-00963	\$499.00
BX44785	BX1320	SPLIT RIM	6"W X 6" D	1320LBS	NO	5/8" X 8"	06-00967	\$485.00
BX44785-4	BX1320	SPLIT RIM	4"W X 6" D	1320LBS	NO	5/8" X 8"	06-00968	\$485.00
BX44863	BX1500	SPLIT RIM	6"W X 6" D	1500LBS	NO	3/4" X 8"	06-00969	\$592.00
BX44863-4	BX1500	SPLIT RIM	4"W X 6" D	1500LBS	NO	3/4" X 8"	06-00970	\$603.00

BLACK MAX AXLE ADAPTERS

Description	Part No.	Price
Challenger Metal Gear Leg	06-00973	\$74.85
Adapter for Challenger w/ Fiberglass Left Gearleg	06-00974	\$81.75
Adapter for Challenger w/ Fiberglass Right Gearleg	06-00975	\$81.75
Hawk Left Axle Assembly	06-00976	\$68.75
Titan Gear LED Adapter	06-00994	\$68.75
Axle 3/4" x 8 w/Woodruff Key	06-01005	\$53.75

BLACK MAX REPLACEMENT PARTS

Mfg. P/N	Description	Part No.	Price
44766	Caliper Assembly 5/8	06-00996	\$161.75
44766-3/4	Caliper Assembly 3/4	06-00997	\$156.75
44764	Master Cylinder Assembly	06-00995	\$126.75
44747	Brake Handle	06-01017	\$19.95
44771	Brake Handle Grip	06-01037	\$3.95
-	Replacement Valve System	06-01013	\$1.95
44743	Black Max Nylon Brake Line 1/8" O.D.	06-01006	\$0.85
44848	Replacement O-Seal Kit (For Split Rims)	06-01012	\$15.00

See www.aircraftspruce.com for more Brake Max Parts

GOODRICH 800X4 WHEEL PARTS

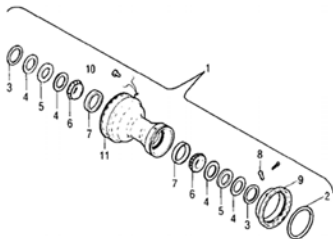

Figure No.	Part No.	Description	Price
5	B227-52	Felt, Grease Retaining	\$1.65
6	08125	Cone, Bearing	\$62.75
7	08231	Cup, Bearing	\$43.50
9	B11-5	Casting, Side	\$56.75
10	AN441-6-6P	Rivet, Brake Drum	\$0.79
11	B13-4	Drum, Brake (I.D. Must be turned after installation.)	\$250.95

GOODRICH WHEEL & BRAKE O-RINGS

Manufacturer	Dimensions (WxLxH)	Part No.	Price
68-448	0.19 in. X 4.07 in. X 0.19 in.	06-02273	\$31.50
68-559	3.88 in. X 3.88 in. X 0.07 in.	06-02274	\$28.95
68-1413	7.63 in. X 10 in. X 2 in.	06-02807	\$225.95
68-1318	8 in. X 10.188 in. X 0.25 in.	06-02806	\$257.95
68-216	8.25 in. X 10.25 in. X 0.11 in.	06-02567	\$59.95

4-1/2 INCH BRAKE BANDS WITH PINS



Band Brakes are simple, effective and economical for a variety of small, light-duty small vehicles, or as parking brakes. They were designed to work with either 4" or 4-1/2" diameter drums, but may work well with drums ranging in size from 3-7/8" through 4-5/8" O.D. • 2 Piece Bonded Lining • Comes with 1 band and 1 pin. • Riveted End/Mounting Brackets • Steel Brake Pin with Cable Hole Included • Band Brake for 4.5" drum - Packaged PN 2555P/N 06-00662 **\$20.50**



SCOTT TYPE DIAPHRAGM FOR BRAKE CYLINDER

Master cylinder diaphragm for Piper J-3/PA-11.
Specifications: • Maximum Working Pressure: 350 lbs • Pedal Pressure: 100 lbs • Recommended Hydraulic Fluid: MIL-H-5606 • Weight as Shown: 21 ounces dryP/N 2844 **\$44.65**



06-00013



06-00430



06-01042

GOODRICH BRAKE ASSEMBLY PARTS FOR ALL PIPERS WITH 8.00 X 4 WHEELS

- Brake Block (750-033)P/N 06-00013 **\$78.99**
- Spring (750-029)P/N 06-00430 **\$7.85**
- Shield (750-093)P/N 06-01042 **\$31.60**

