

SHIMMY DAMPERS – HUB CAPS – GOODRICH

PIPER SHIMMY DAMPER SERVICING KIT

Finally, a shimmy damper servicing kit. One of the most neglected components on Piper aircraft is the shimmy dampener. The shimmy damper aids nose wheel steering by reducing the shimmy of the nose wheel during takeoff and landing, and during high-speed taxiing. Even minor shimmying can lead to serious damage to the nose gear and engine mount and affect the airworthiness of the aircraft. The shimmy damper is a sealed unit that, until now, could not be serviced and required costly replacement. The STC and accompanying servicing kit allows the MAECO shimmy damper to be modified and serviced, restoring the shimmy damper to like-new condition and enabling it to perform as originally designed Important: Enter Piper Aircraft Model, Serial number, and "N" number at time of order.....P/N 06-00846 ----

SEE WEBSITE FOR AIRCRAFT ELIGIBILITY!

SHIMMY DAMPENER REPAIR KITS

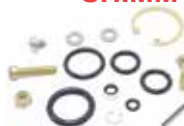

TSDK-1 & TSDK-2 Shimmy Damper Repair Kits. Replaces the Cleveland 199-535 kit.

Specifications:

Kits Service the: 15-2, 15-8 (456-015), 15-9 (456-016), 15-10 (456-017), 15-11 (456-018), 15-13, 15-14 (456-014) and 15-16.

TSDK-1.....P/N 04-04055 ----
TSDK-2 with Glyd Ring.....P/N 04-04056 ----

METAL HUB CAPS



These FAA approved metal hub caps are designed for older Pipers using the 800x4 Goodrich (Hayes) brakes such as the J-3 and PA-18. A larger cap for 600 x 6 conversions are also available below. The caps are available with "CUB" stamped in raised letters or plain.

Cub 800x4 Goodrich hub capP/N 06-00010 ---- ea.
(Identical in size and appearance to Cleveland #157-9)
Cub 600x6 Cleveland hub cap.....P/N 06-00020 ---- ea.
Plain 800x4 Goodrich hub cap.....P/N 06-00030 ---- ea.
Plain 600x6 Cleveland hub cap.....P/N 06-00040 ---- ea.

GROVE HUB CAPS



GROVE HUB CAP 5"

For Grove, Cleveland and Gerdes wheels. Includes mounting screws. 011-012

P/N 06-01363 ----



GROVE HUB CAP 6"

For Grove, Cleveland and Gerdes 600x6 wheels. Includes mounting screws. 011-013

P/N 06-00845 ----

GOODRICH 800X4 WHEEL PARTS

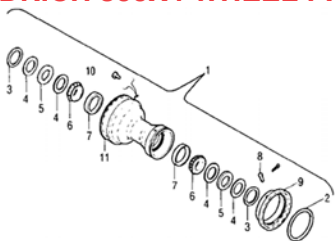

Figure No.	Part No.	Description	Price
5	B227-52	Felt, Grease Retaining	---
6	06-04699	Cone, Bearing	---
7	08231	Cup, Bearing	---
9	B11-5	Casting, Side	---
10	AN441-6-6P	Rivet, Brake Drum	---
11	B13-4	Drum, Brake (I.D. Must be turned after installation.)	---

GOODRICH WHEEL & BRAKE O-RINGS

Manufacturer	Dimensions (WxLxH)	Part No.	Price
68-448	0.19 in. X 4.07 in. X 0.19 in.	06-02273	---
68-559	3.88 in. X 3.88 in. X 0.07 in.	06-02274	---
68-1413	7.63 in. X 10 in. X 2 in.	06-02807	---
68-1318	8 in. X 10.188 in. X 0.25 in.	06-02806	---
68-216	8.25 in. X 10.25 in. X 0.11 in.	06-02567	---

MC0442512-1 SHIMMY DAMPENER ASSEMBLY FOR CESSNA



Direct replacement for part numbers 0442512-1 and 0542119-1. It's everything the original should have been and more than the rubber units ever could be! • Improved design for consistent dampening action! • Oversize shaft for rigid strength • Wear resistant hard anodized housing • Better shimmy dampening • Totally repairable • Self lubricating • Costs less than the throw away rubber dampener • Temperature compensated hydraulics • Almost no service required • Even the first minor movements are dampened • Consistent dampening action • No oil leaks. P/N 05-22192 ----

SEE WEBSITE FOR AIRCRAFT ELIGIBILITY!

SEAL KITS FOR CESSNA SHIMMY DAMPENERS



Shimmy damper seal kits contain the industry standard o-rings required to reseal the Cessna shimmy damper.

Visit our website for application information.

Economy Kit.....P/N 06-01679 ----

WHEEL COVERS



For Gerdes, McCauley, Cleveland, Hayes, Goodyear, Rosenhan and Matco wheels as listed. Furnished with mounting screws and lock washers.

157-8

Part No.	Wheel Size	Application	Price ea.
157-8	5.00-5*	Cleveland, McCauley, Gerdes	---
157-9	6.00-6**	Cleveland, McCauley, Gerdes	---
06-03705	6.00-6	All Goodyear Wheels	---
06-03900	5" Dia.	Rosenhan Matco Wheels	---

ECONOMY WHEEL COVER



For 600-6 Cleveland wheels

P/N 06-03710 ---- ea.

For 500-5 Cleveland wheels

P/N 06-00073 ---- ea.

Furnished with screws for installation

4-1/2 INCH BRAKE BANDS WITH PINS



Band Brakes are simple, effective and economical for a variety of small, light-duty small vehicles, or as parking brakes. They were designed to work with either 4" or 4-1/2" diameter drums, but may work well with drums ranging in size from 3-7/8" through 4-5/8" O.D. • 2 Piece Bonded Lining • Comes with 1 band and 1 pin. • Riveted End/Mounting Brackets • Steel Brake Pin with Cable Hole Included • Band Brake for 4.5" drum - Packaged P/N 2555P/N 06-00662 ----

SCOTT TYPE DIAPHRAGM FOR BRAKE CYLINDER



Master cylinder diaphragm for Piper J-3/PA-11.

Specifications: • Maximum Working Pressure:

350 lbs • Pedal Pressure: 100 lbs • Recommended

Hydraulic Fluid: MIL-H-5606 • Weight as Shown: 21

ounces dryP/N 2844 ----



06-00013



06-00430



06-01042

GOODRICH BRAKE ASSEMBLY PARTS FOR ALL PIPERS WITH 8.00 X 4 WHEELS

Brake Block (750-033).....P/N 06-00013 ----
Shield (750-093).....P/N 06-01042 ----